

Cub Cadet[®]

Power Equipment

Owner's Manual

**REAR WEIGHT BRACKET KIT
190-447-100**

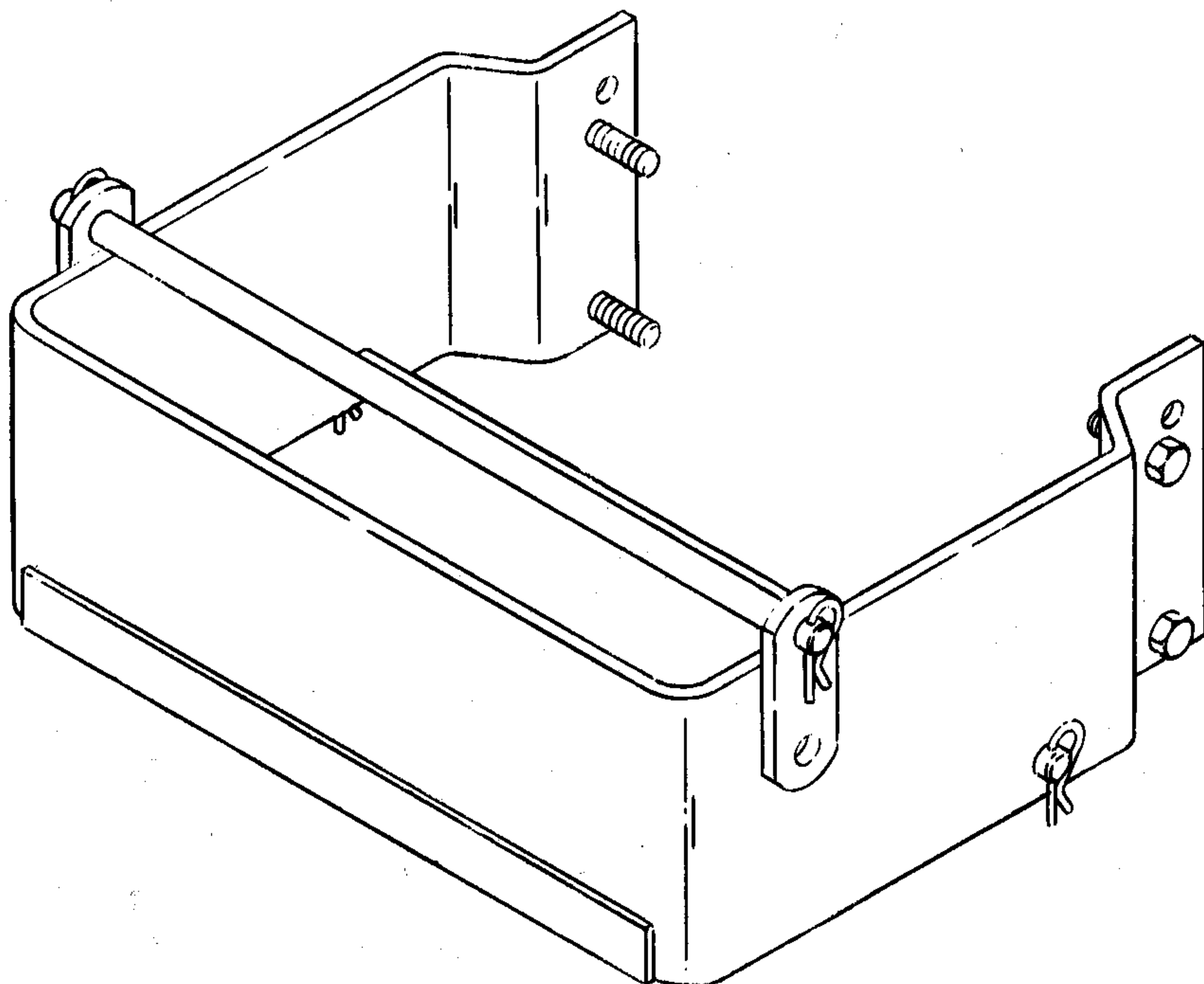

INSTALLATION INSTRUCTIONS

**Important:
Read Safety Rules and Instructions Carefully**

Thank you for purchasing an American-built product
CUB CADET CORPORATION • P.O. BOX 368023 • CLEVELAND, OHIO 44136-9723

TO THE OWNER

Contained in this manual are instructions covering the installation of the Rear Weight Bracket Kit (190-447-100) to your tractor. Installation of weights (759-3388) for use on the bracket is also explained.

The Rear Weight Bracket Kit and a minimum of 3 and a maximum of 5 weights **MUST** be used on tractors utilizing front mounted equipment. Each weight weighs 42 pounds.

The weights are purchased separately and can be obtained through your local authorized *Cub Cadet* dealer. Weight part number is 759-3388.

Before beginning installation, refer to Figure 1 to familiarize yourself with the parts and nomenclature of the Rear Weight Bracket Kit.

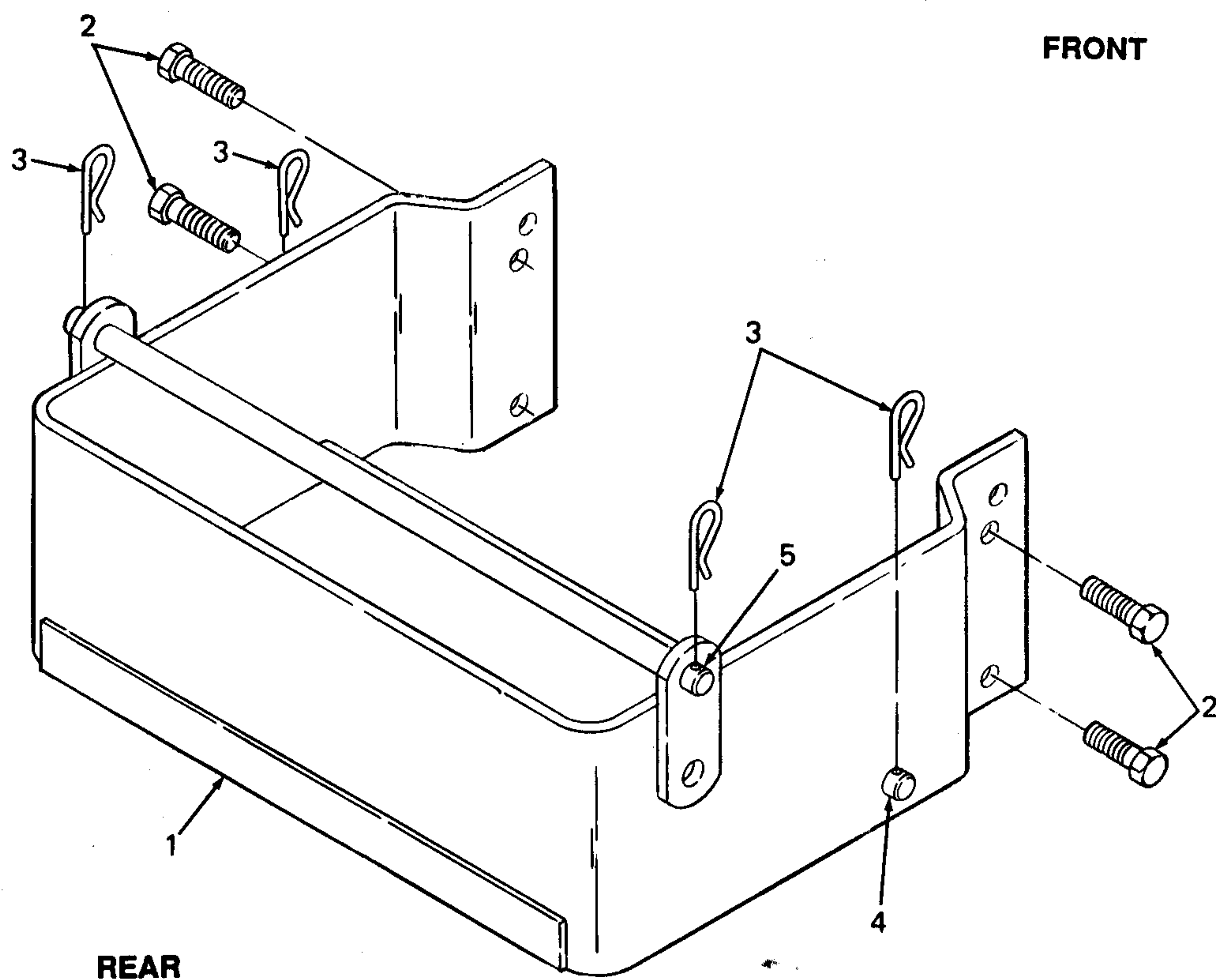

Figure 1

- | | |
|---------------------------------|------------------------|
| 1. Rear Weight Bracket Assembly | 4. Bracket Support Rod |
| 2. Hex Screw | 5. Weight Support Rod |
| 3. Hairpin Cotter | |

INSTALLATION OF REAR WEIGHT BRACKET KIT TO TRACTOR

NOTE

Rear weight bracket kit **CANNOT** be installed on Super Garden Tractors with a 3-point hitch.

Standard Garden Tractors with a 3-point hitch require removal of some parts of the hitch assembly before the rear weight bracket can be installed.

Refer to Figure 2 and remove chains, center clevis screw, clevis tubing, adjustment links and draft bars.

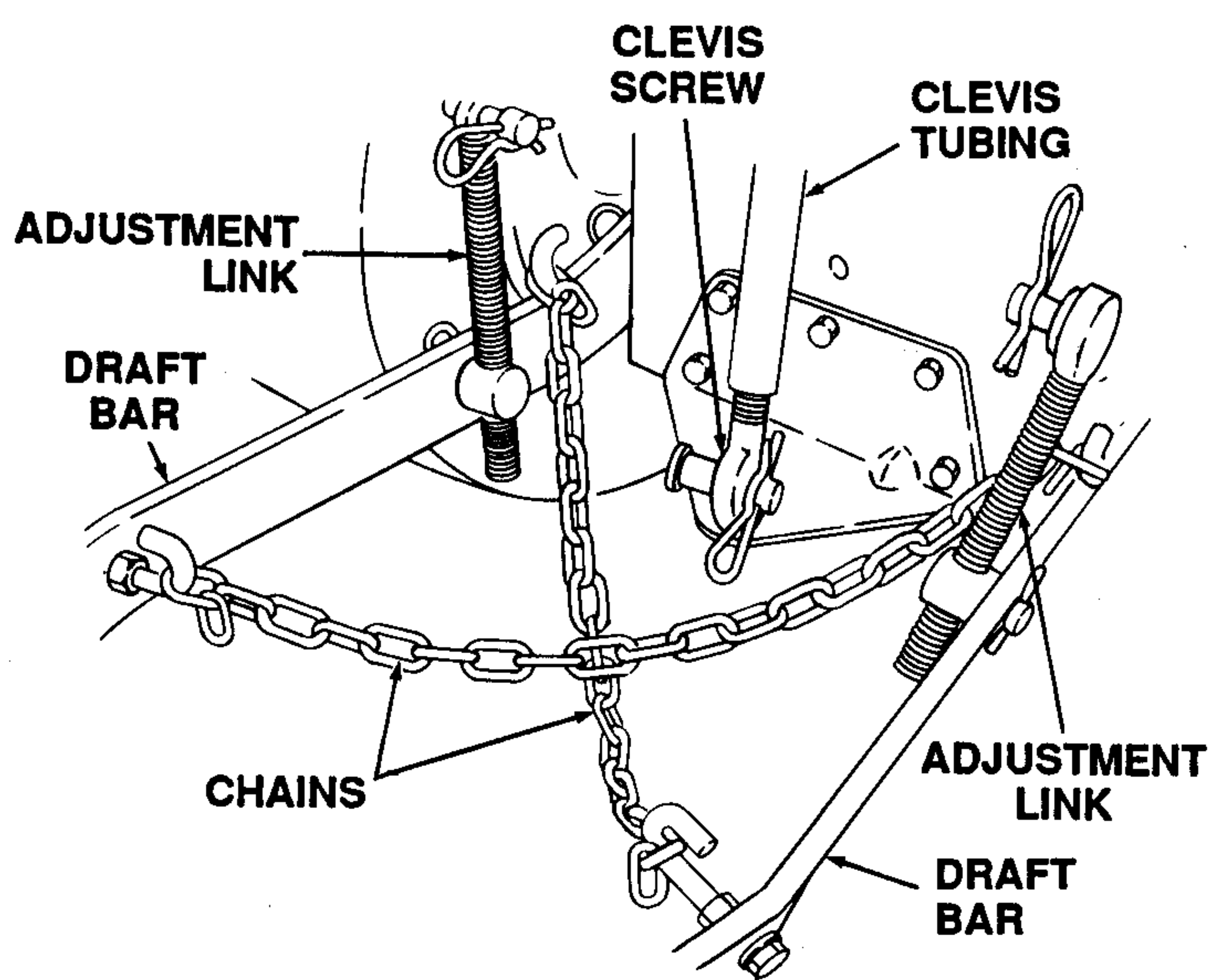

Figure 2



WARNING

Before installing rear weight bracket kit, stop the tractor engine, disengage the PTO, place all controls in neutral and engage the brake lock.

1. Remove bracket support rod and weight support rod if assembled to rear weight bracket. See Figure 1.
2. Refer to Figure 3 and remove lower hex cap screws and lock washers that mount rear hitch plate to frame. Save lock washers.
3. Assemble weight bracket to frame using lower hole in bracket and lower hole in frame. Mount bracket on both sides of frame using new hex cap screws supplied in kit and existing lock washers. Do not tighten cap screws.

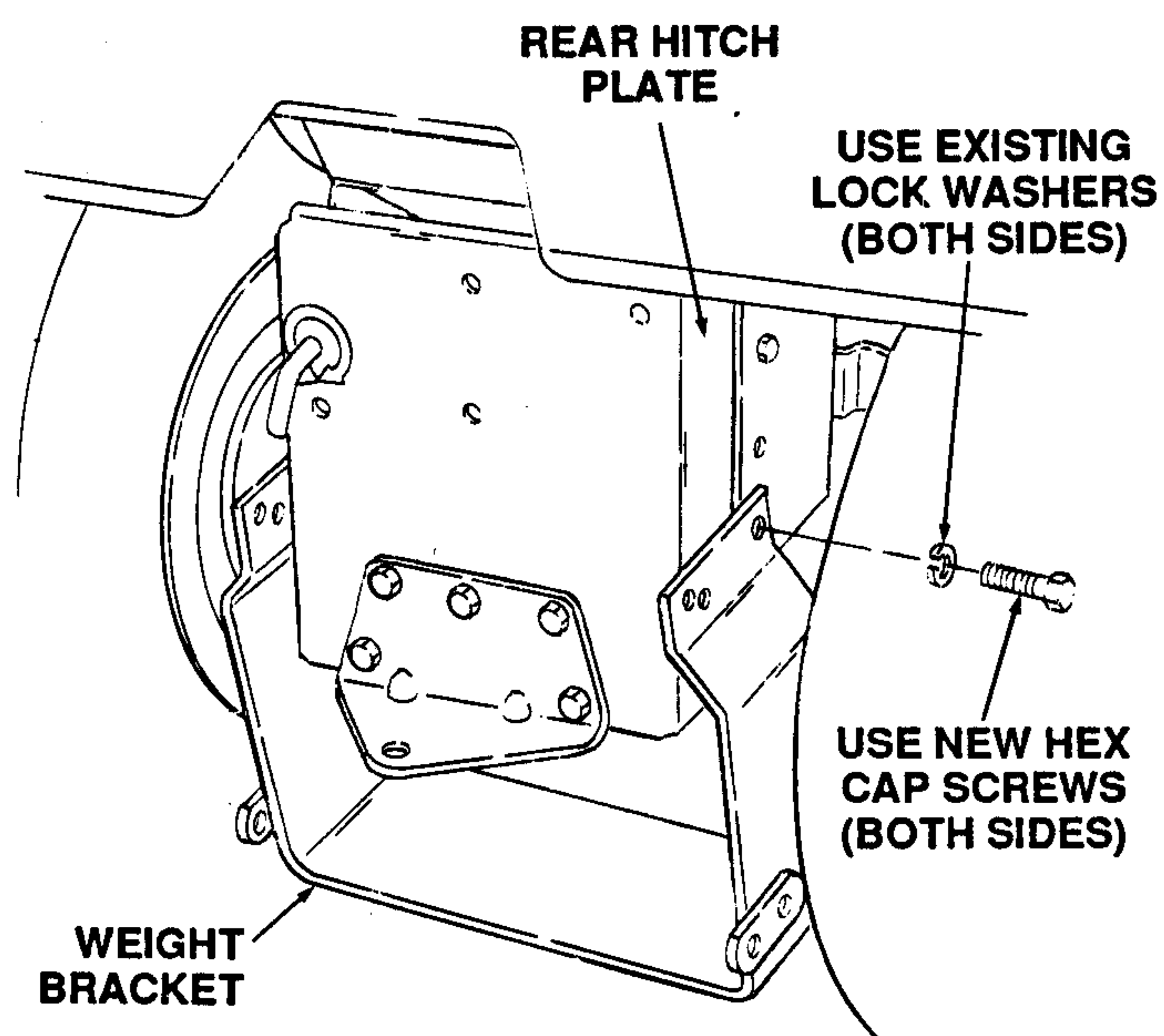

Figure 3

4. Refer to Figure 4 and remove upper hex cap screws and lock washers that mount rear hitch plate to frame. Save lock washers.

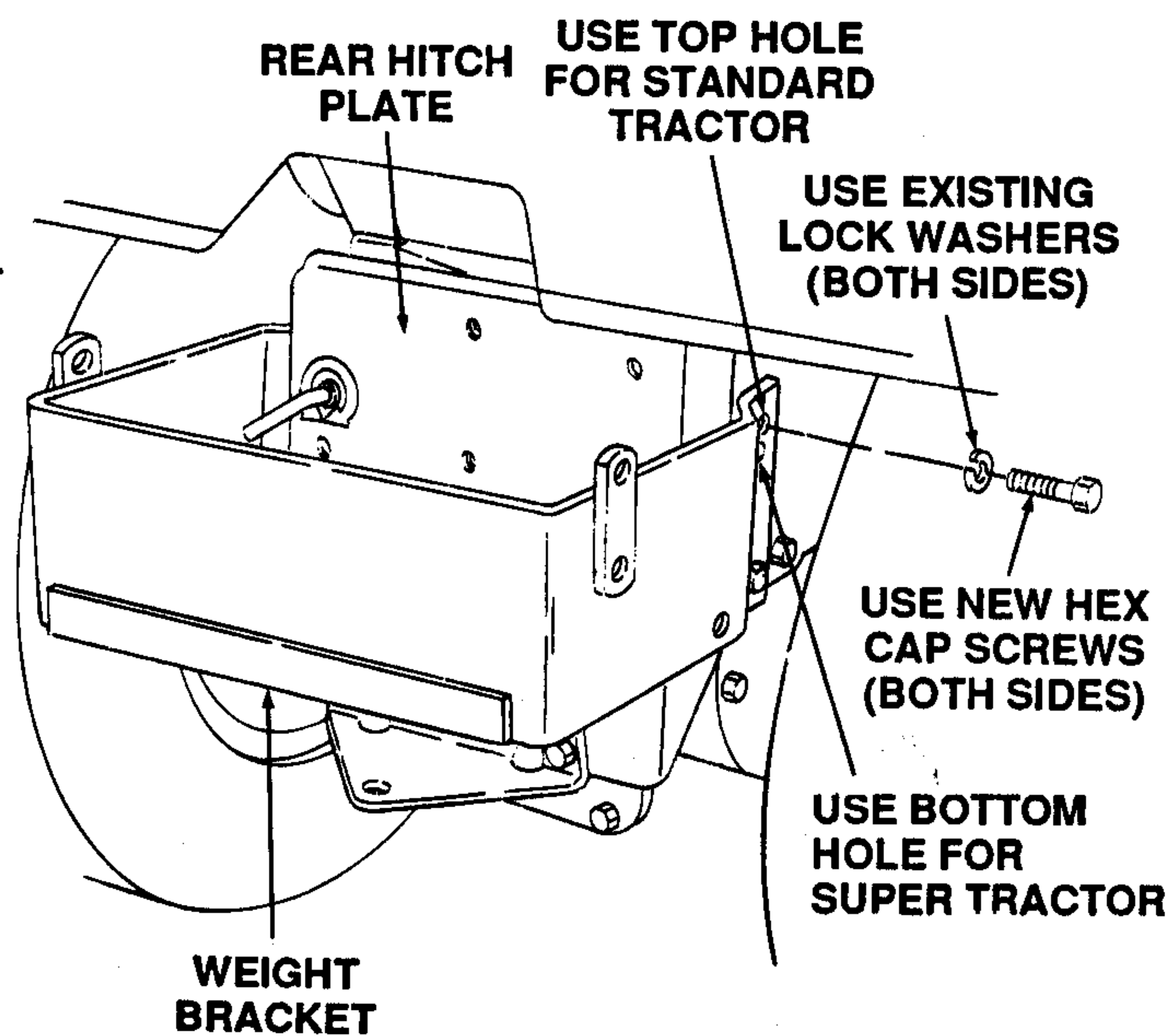

Figure 4

5. Pivot bracket up and mount to both sides of frame using new hex cap screws supplied in kit and existing lock washers. Do not tighten cap screws.



NOTE

When assembling bracket to standard tractor use top hole for mounting. When assembling bracket to super tractor use second hole for mounting. See Figure 4.

- Slide bracket support rod into left hole in weight bracket from the inside as shown in Figure 5 and then into hole on right side of bracket.

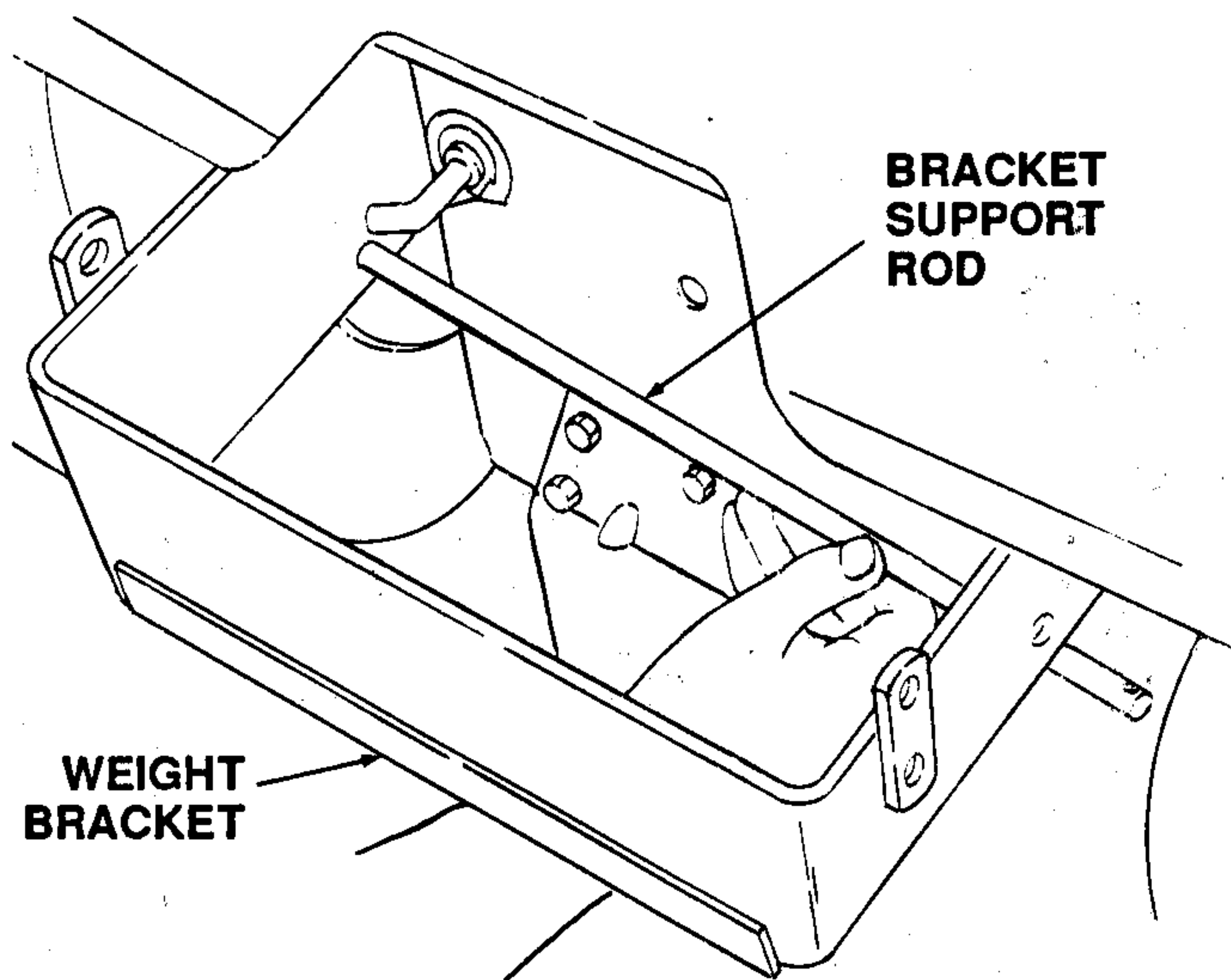

Figure 5

- Attach hairpin cotters to both sides of bracket support rod as shown in Figure 6. Tighten the four mounting hex cap screws.

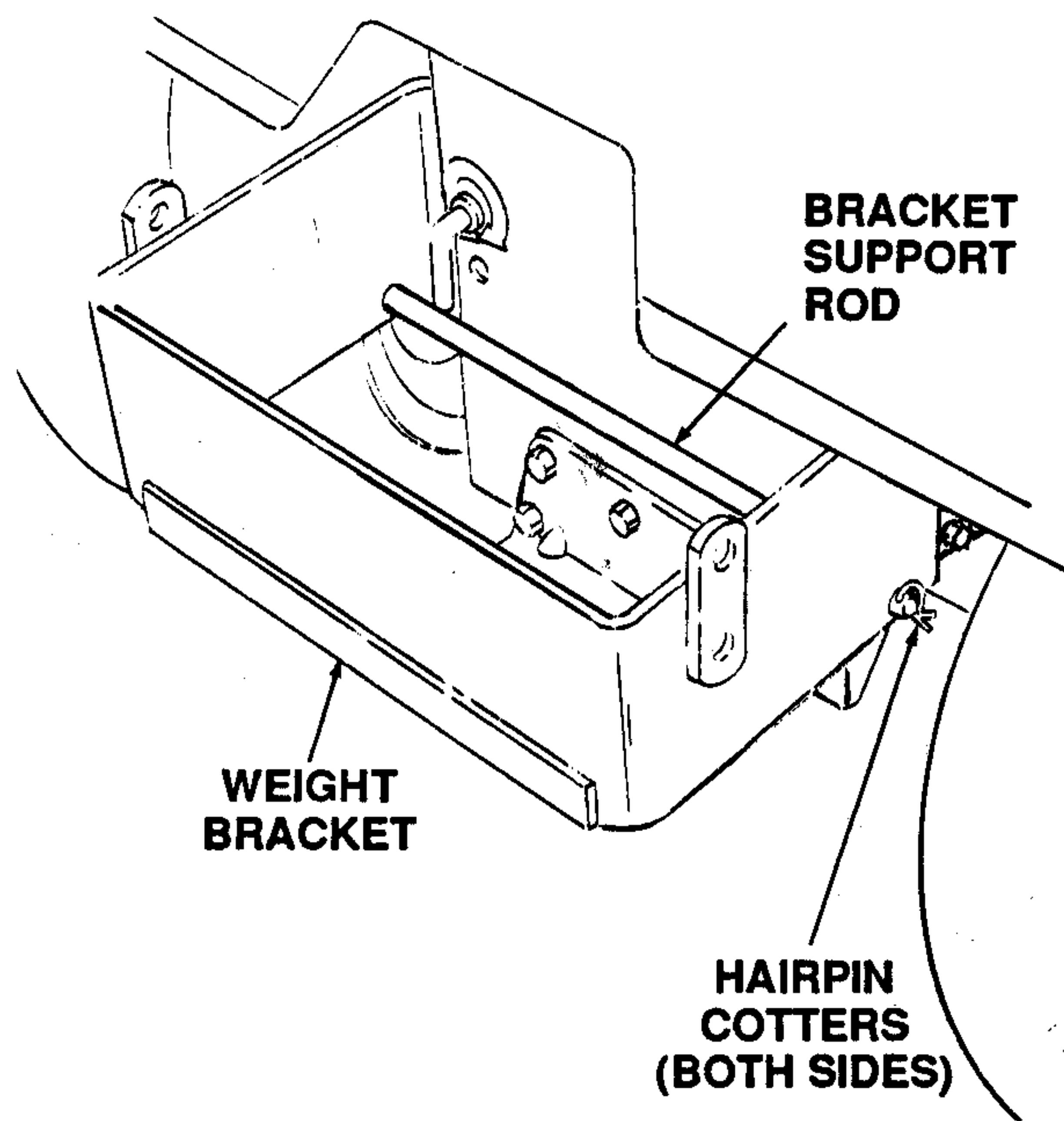

Figure 6

INSTALLATION OF WEIGHTS (759-3388) TO REAR WEIGHT BRACKET

Refer to Figure 7 and proceed as follows:



WARNING

A minimum of 3 and a maximum of 5 weights must be used when utilizing front mounted equipment.

- Place weights on rear weight bracket as shown in Figure 7.

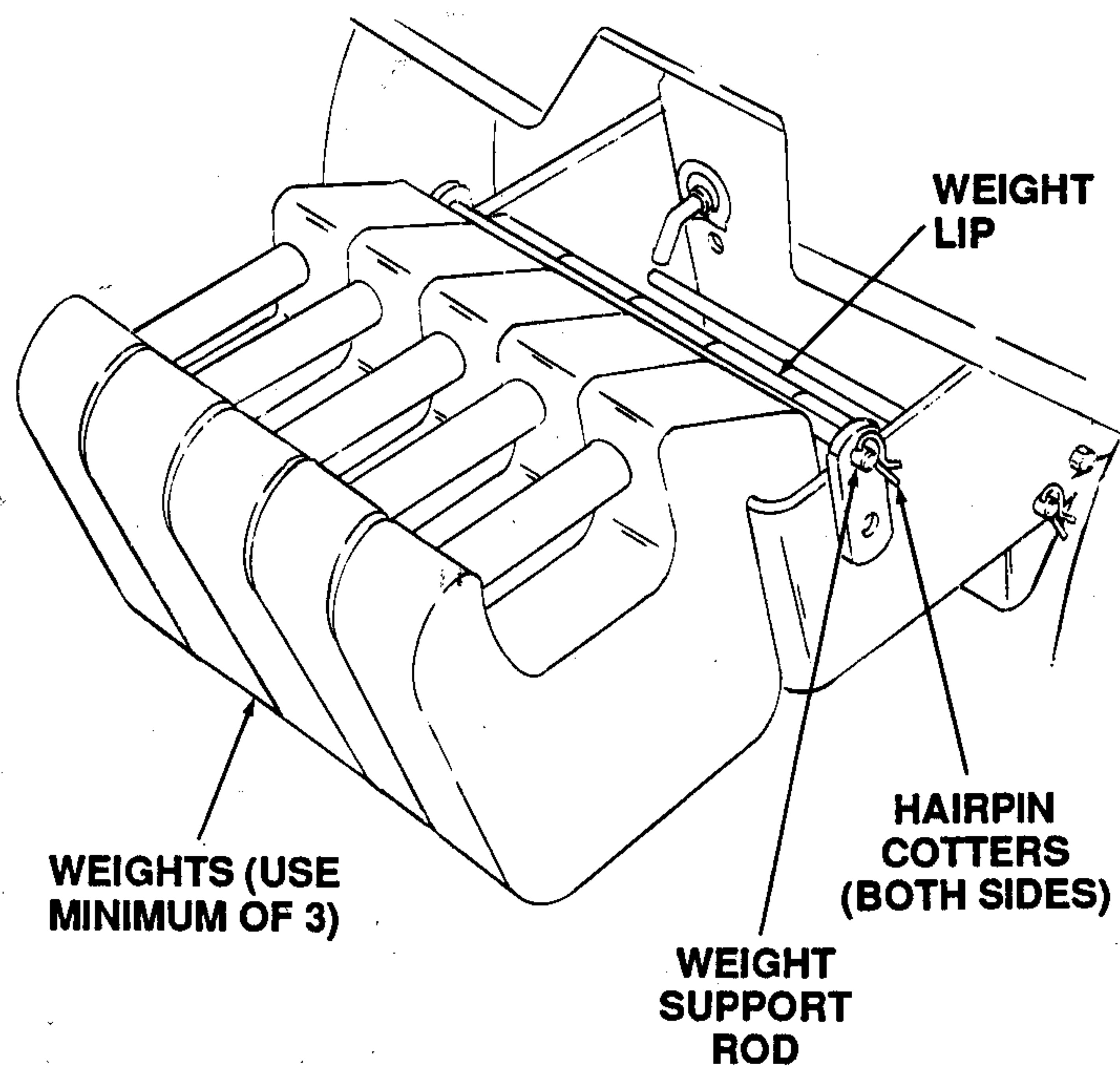

Figure 7

- Slide weight support rod through holes in tabs on bracket making sure the rod is positioned directly OVER the lip of each weight. Secure rod with hairpin cotters on both sides.



CAUTION

Following installation of weights, pull upward on each weight to confirm that it is securely positioned.